

5/147-151 President Avenue Miranda NSW

3 2 2

Discover contemporary living at its finest with this stunning property, currently leased at \$900 per week.

Boasting a modern terrace-style design, this abode offers open-plan living areas that seamlessly extend to the private terrace courtyards taking full advantage of the sunny north-facing aspect.

Experience convenience at its best with an internally accessible double secure side-by-side garage and storage room, as well as a video intercom system and lift access from the basement level for added security. Enjoy meticulously landscaped grounds that surround the complex and create a peaceful environment for residents to relax and unwind.

This property also features high ceilings, exquisite fixtures,

Price : \$ 1,110,000
Building Size : 112 sqm
Land Size : 228 sqm
View : <https://www.singerresidential.com.au/7532575>



Joel Bethell
02 9528 8738



Joshua Singer
02 9528 8738

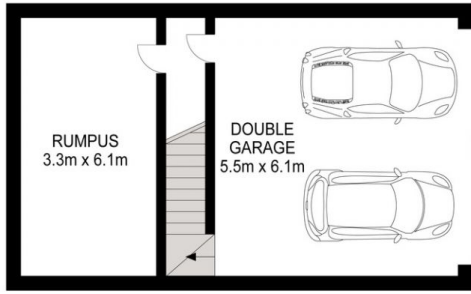

GROUND FLOOR

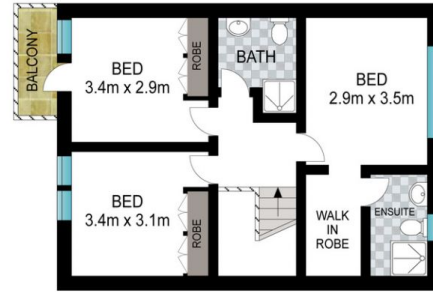

SECOND FLOOR



FIRST FLOOR



Scale in metres. Indicative only. Dimensions are approximate. All information contained herein is gathered from sources we believe to be reliable. However, we cannot guarantee its accuracy and interested persons should rely on their own enquiries.

INT: 163 m²
EXT: 36 m²



5/147 President Avenue, Miranda