



4/289-291 The Boulevard Miranda NSW

3 3 2

- three bedrooms all with built-in robes
- full-sized ensuites to master bedrooms
- sleek designer kitchens with island bench and quality Miele appliances
- designed by well renowned Couvaras Architects
- North facing aspect to living and alfresco entertaining courtyards
- convenient double basement garaging with internal access
- ample storage solutions throughout
- pet friendly
- easy access to major shopping complex, schools and sporting facilities
- Smart system wired throughout

Price : \$ 1,240,000
Building Size : 169 sqm
Land Size : 255 sqm
View : <https://www.singerresidential.com.au/6501237>



Joel Bethell
02 9528 8738



Joshua Singer
02 9528 8738

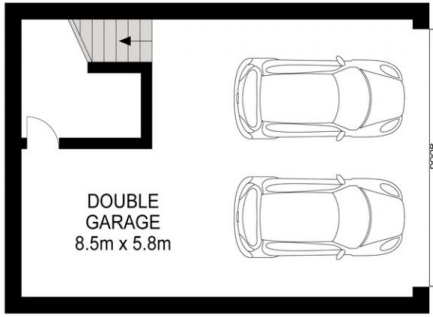

BASEMENT

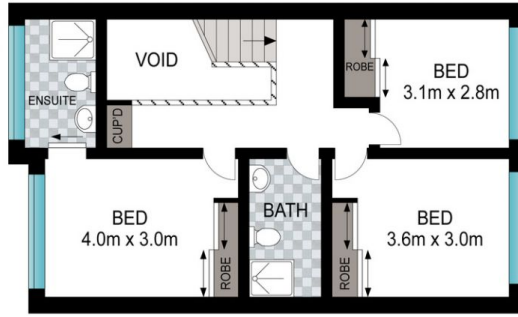

FIRST FLOOR

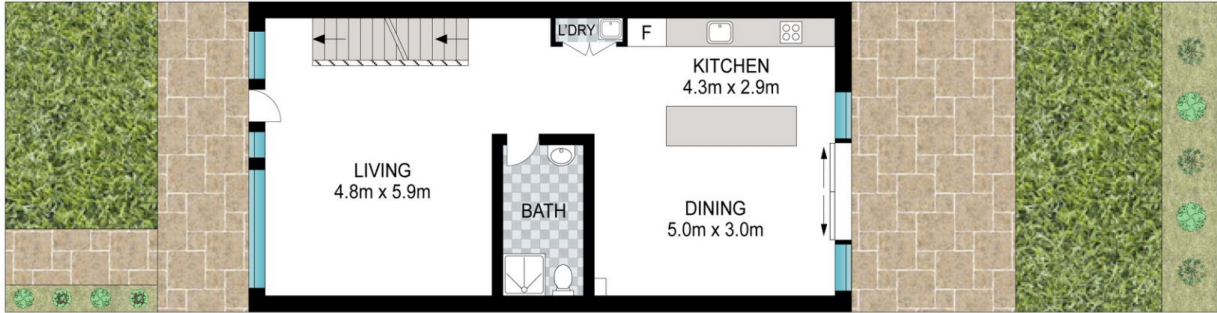

GROUND FLOOR



INT: 175 m²
EXT: 30 m²



Scale in metres. Indicative only. Dimensions are approximate. All information contained herein is gathered from sources we believe to be reliable. However, we cannot guarantee its accuracy and interested persons should rely on their own enquiries.

4/289 The Boulevard, Miranda