

## 393 The Boulevarde GyMEA NSW

3 1 4

This original 3 bedroom family brick home is located on the corner of The Boulevard and Princes Highway presents a great opportunity for first home buyers, tradies, or anyone who is self-employed to advertise your own business to 1000's of people a day due to the high exposure.

### Features include:

- ? 3 bedrooms with built-in wardrobes
- ? Potential for dual access
- ? Polished timber floors throughout
- ? Double lock up garage with additional car spaces
- ? Huge under house storage
- ? Grassed backyard
- ? Side access for boat or caravan parking
- ? Soundproof windows throughout

**Land Size** : 526 sqm  
**View** : <https://www.singerresidential.com.au/6473744>



**Joshua Singer**  
02 9528 8738



**Joel Bethell**  
02 9528 8738

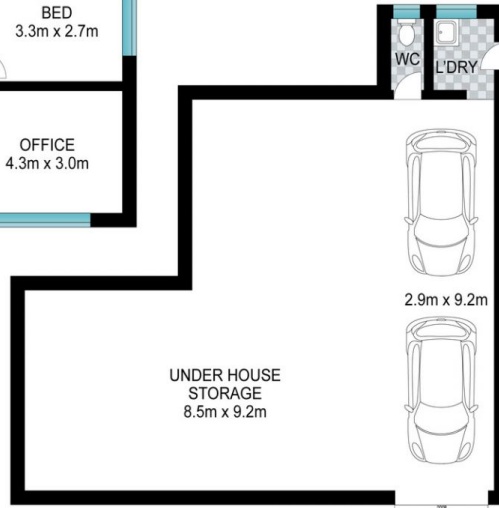

**SITE PLAN**



Scale in metres. Indicative only. Dimensions are approximate. All information contained herein is gathered from sources we believe to be reliable. However, we cannot guarantee its accuracy and interested persons should rely on their own enquiries.

INT: 194 m<sup>2</sup>  
EXT: 9 m<sup>2</sup>



393 The Boulevard, Gymea