



26 Foveaux Place Barden Ridge NSW

4 2 5

Looking to live in one of the shire's most sought-after locations? This Beautiful 4/5 bedroom family home is located in Barden Ridge's most highly desired Cul de Sac's which is a perfect family oasis for anyone wishing to move.

Land Size : 1009 sqm
View : <https://www.singerresidential.com.au/6440010>

This property is loaded with features which include:

- ? Garage conversion offering separate office space great for gym/studio medical practice, home business with internal and external access, and access to rear decking.
- ? Separate toilet, fully renovated family bathroom, heated towel rails floor to ceiling tiles in all bathrooms.
- ? All bedrooms offer built-in wardrobes with carpeted flooring, a Master bedroom with ensuite, and a large walk-in wardrobe.
- ? A huge kitchen with pantry all drawers soft-closing, island benchtop/breakfast bar. The kitchen features a wine fridge,



Trisha Singer
0405143152



Annabelle Young
0468789745

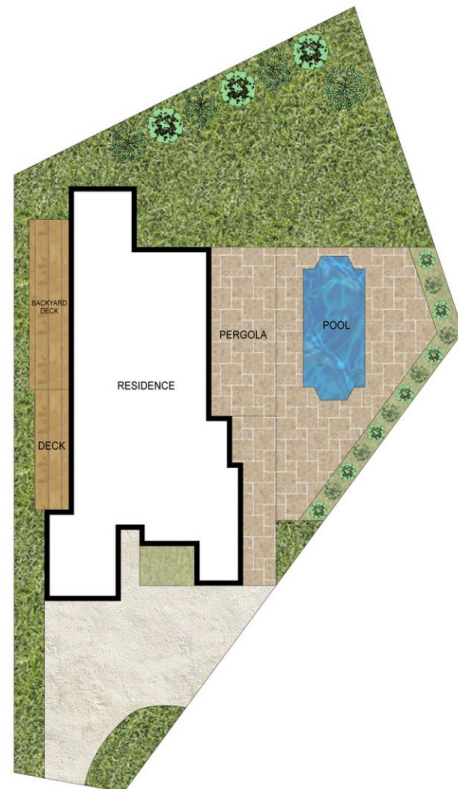

SITE PLAN



Scale in metres. Indicative only. Dimensions are approximate. All information contained herein is gathered from sources we believe to be reliable. However, we cannot guarantee its accuracy and interested persons should rely on their own enquiries.

INT: 250 m²
EXT: 100 m²

26 Foveaux Place, Barden Ridge